



Systems feature

- screw connection is easy to operate
- plug in system easy to service
- easily detachable connection
- number of poles 2 – 24
- clear straight forward interconnection
- horizontal and vertical configurations
- individually matched to the relevant application
- terminal clamping part with wire protection



Marking

- ink jet printing directly onto the terminal using indelible ink
- clear pole marking which is easy to read
- special marking is possible on request
- economical marking directly onto the terminal



Type range

- pitch (3.5/7/5/10) mm
- 2 – 24 pole
- pin strips with straight or angled pins
- pin diameters 0.8 mm, 1 mm and 1.3 mm



Two part PCB Terminals

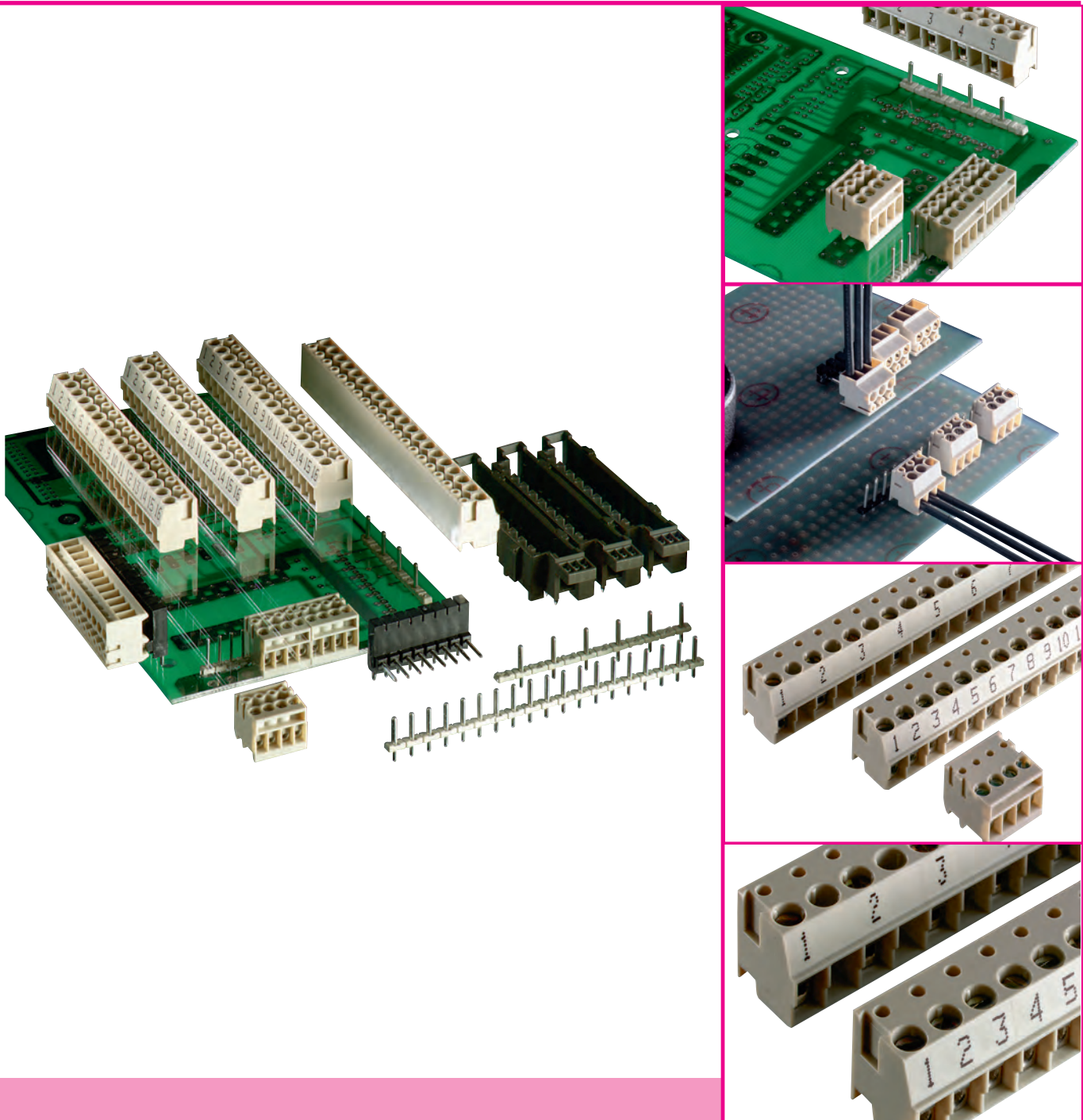

PCB screw terminal series 8142, two part PCB terminal raising cage clamp

pitch 5.00 mm

IEC	250 V 2.5kV cat.3	8 A (40 °C) 3 A (70 °C)	0.14 - 1.5 mm ² (Stranded) 0.14 - 1.5 mm ² (Solid)
UL	300 V	8 A	22 -12 AWG
CSA	300 V	5 A	22 -12 AWG
Solder Pin	1.0 x 1.0 mm		
Drill Hole	1.3 mm		
Wire Strip Length	6 mm		
Screw Size	M3		



See Technical Data section for screw material options

Approvals:

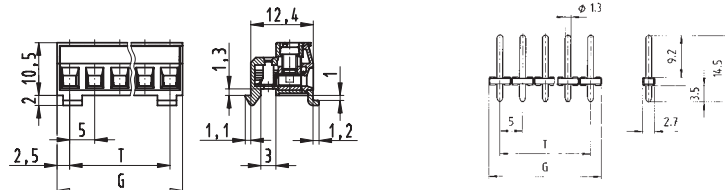

series 8142 Z RF OB pitch 5.00 mm

Box Qty	G	T	Pole
100	10	5	2
100	15	10	3
50	20	15	4
50	25	20	5
50	30	25	6
50	35	30	7
50	40	35	8
50	45	40	9
50	50	45	10
50	55	50	11
50	60	55	12
50	65	60	13
50	70	65	14
50	75	70	15
50	80	75	16

unmarked

THR
box

THR
tape on reel

Part Number	Part Number	Part Number	Part Number
27.602.6253.0		Z5.530.0204.0	Z5.530.0214.0
27.602.6353.0		Z5.530.0304.0	Z5.530.0314.0
27.602.6453.0		Z5.530.0404.0	Z5.530.0414.0
27.602.6553.0		Z5.530.0504.0	Z5.530.0514.0
27.602.6653.0		Z5.530.0604.0	Z5.530.0614.0
27.602.6753.0		Z5.530.0704.0	Z5.530.0714.0
27.602.6853.0		Z5.530.0804.0	Z5.530.0814.0
27.602.6953.0		Z5.530.0904.0	Z5.530.0914.0
27.602.7053.0		Z5.530.1004.0	Z5.530.1014.0
27.602.7153.0		Z5.530.1104.0	Z5.530.1114.0
27.602.7253.0		Z5.530.1204.0	Z5.530.1214.0
27.602.7353.0			
27.602.7453.0			
27.602.7553.0			
27.602.7653.0			

Box Qty	G	T	Pole	Part Number	Part Number	Part Number	Part Number

